

Washing Technology

Semi - Automatic Systems

Different Washing Systems

Conventional:

Manual Processing of

- Dishware
- Silverware
- Trays

Semi - Automatic:

Manual Processing of

- Dishware

Automatic Processing of

- Silverware and
- Trays

Fully Automatic:

Automatic Separation &

Processing of

- Plates
- Bowls
- Silverware
- Trays







Characteristics of Semi - Automatic

HOBART

- ➔ Outstanding Wash & Drying Results
- ➔ Safe & Proven Technology
- ➔ Lower Consumption of Water, Energy, Chemicals
- ➔ Observation and Monitoring of the Hygienic Parameter
- ➔ Silverware Magnet / Silverware Track
- ➔ Automatic Tray Loading / Tray Track

The Cleaning Process

HOBART

Tray / Silverware Feeding		Automatic
Washing		Circulating Process at 60° C & Chemicals
Cleaning		With Hot Water at 85° C
Drying		Heated Air 55° C
Tray Stacking		Automatic
Silverware Collection		Manual (Automatic: Optional)

Flight-Type Dishwashing Machine Series FTN

HOBART

Tray / Silverware Machine
Porcelain Machine



Proven FTN-Technology

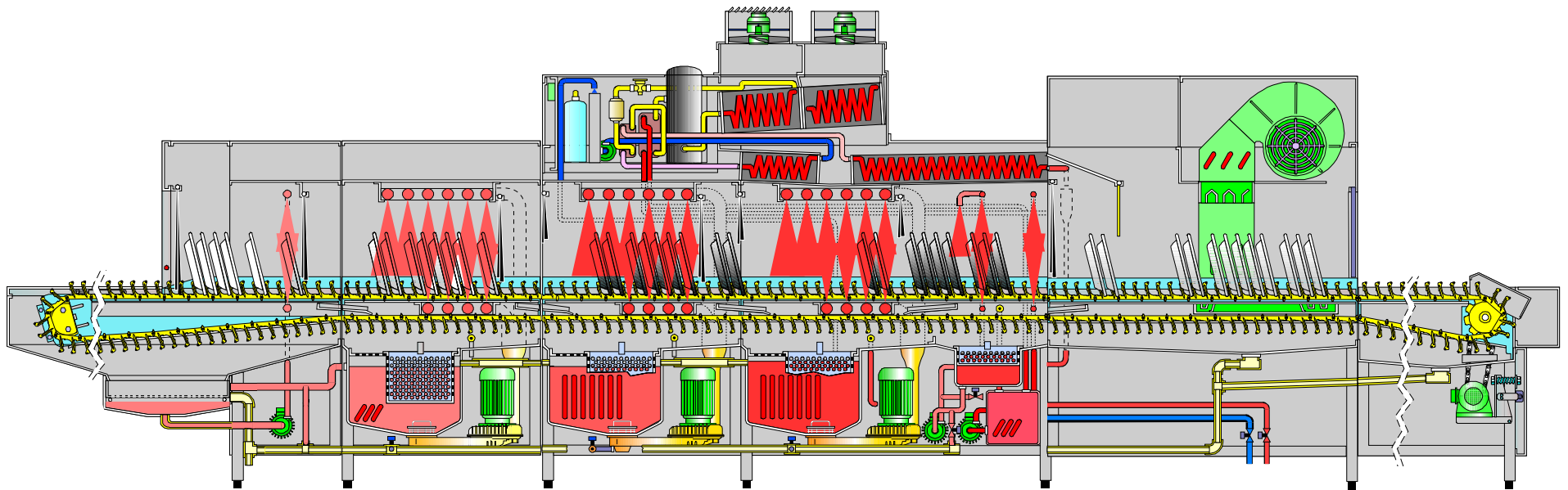

Shown: FTN 2 ES-B-DS 6 With Heat Pump

The FTN - Semi - Automatic

HOBART

The Semi - Automatic System Consists of:



1.) The Porcelain Machine

(Manual Handling of Plates, Bowls, Insulated Covers etc.)

2.) The Tray / Silverware Cleaning Machine

(Automatic Handling of Trays and Silverware)

The Porcelain Machine

HOBART

Custom Made Multi - Purpose Washer

Loading Section:

- Standard Loading

max. 2 Stripping Areas
up to ca. 20 Parts Handled / min.

- Lowered Loading (See Picture)

max. 4 Cleaning Areas
up to ca. 40 Tray Items Handled / min.



Machine with Lowered Input

The Tray Loading:

- Input up to 30 Trays / min
- Simple Design
- Separate Drive Unit

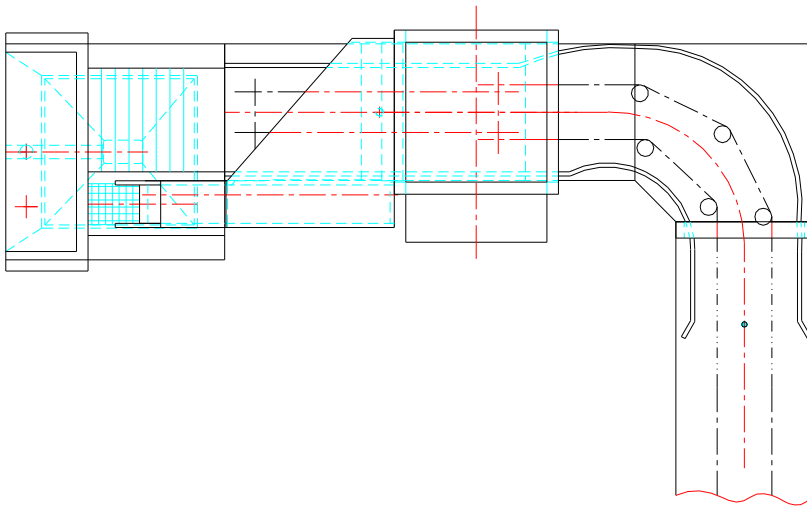

The HOBART- Silverware Collection Magnet:

- Safe Operation Through High-Quality Permanent Magnet
- Easy to Clean, Stable Outer Covering
- Robust Construction in Stainless Steel

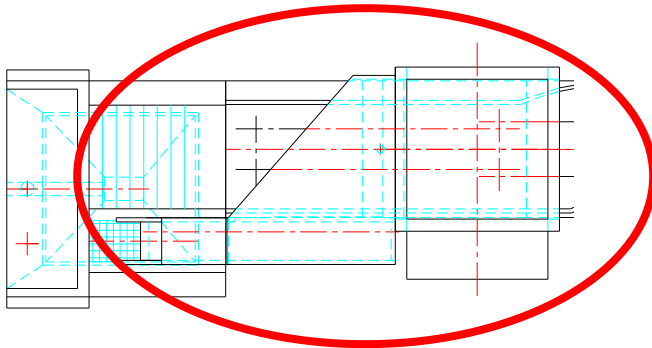

The Automatic Tray Stacker:

- Safe Operation Through Proven Technology
- Possible For All Tray Measurements
- Fitting for Commercial (Low Modified) Tray Stacks
- Between Batching Optional

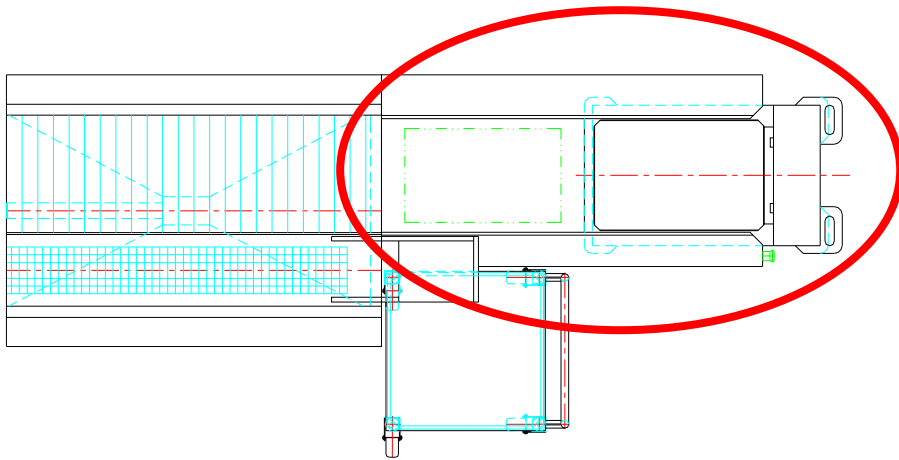

Consumption and Connections

HOBART

Model: FTN YS-A-DSX, 612/440 (for Trays 460x344 mm)

Heating	Electric	Steam	Heat Pump (E)
Cold Water Consumption (soft)	385 l/h	385 l/h	425 l/h
Warm Water Consumption Filling	236 l	236 l	236 l
Electric Connection	52 kW	9 kW	41 kW
Steam Connection		75 kg/h	
Output Air in m ³ /h	Ca.	Ca.	Ca.
Output Air Temp.	40 °C	40 °C	18 °C

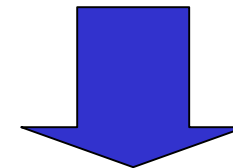

Air Conditioning
Effect

HOBART PROtronic-PLUS



- 4 - Level Display
- Detailed Malfunction Display
- Interface RS 232
- Variable Adjustable Time Cycles

Option: Visualisation With the HOBART- Megatronic

Sample Planning of Semi - Automatic

HOBART

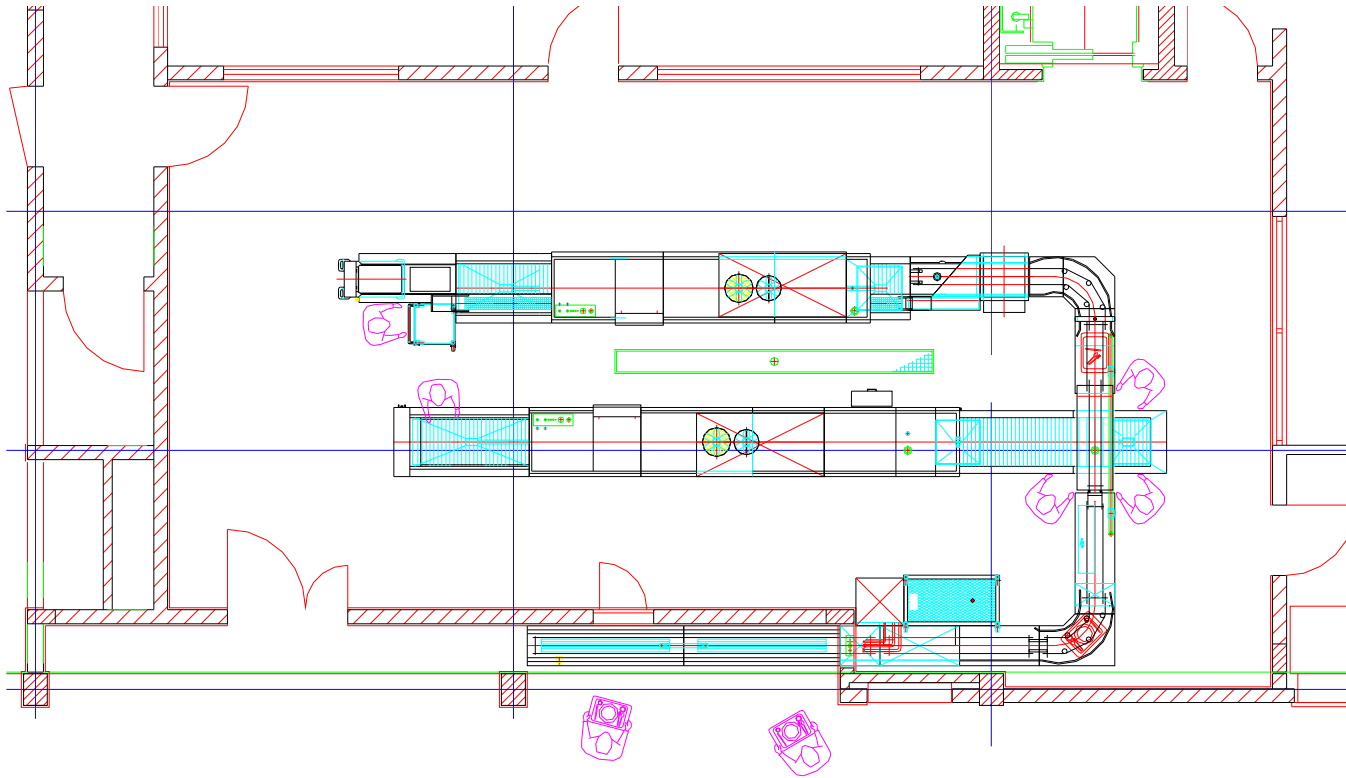

Tray Return Area

Sample Planning of Semi - Automatic

HOBART

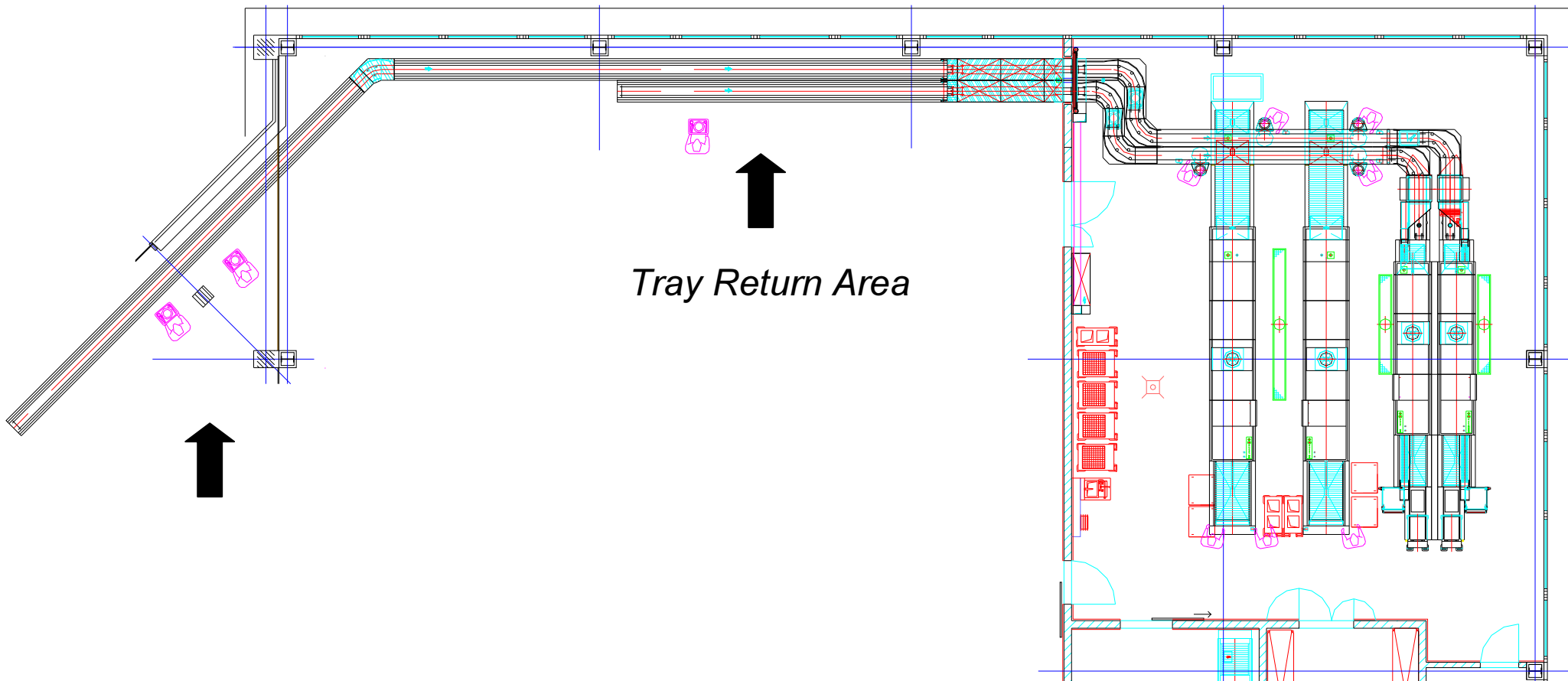

Sample Planning of Semi - Automatic

HOBART

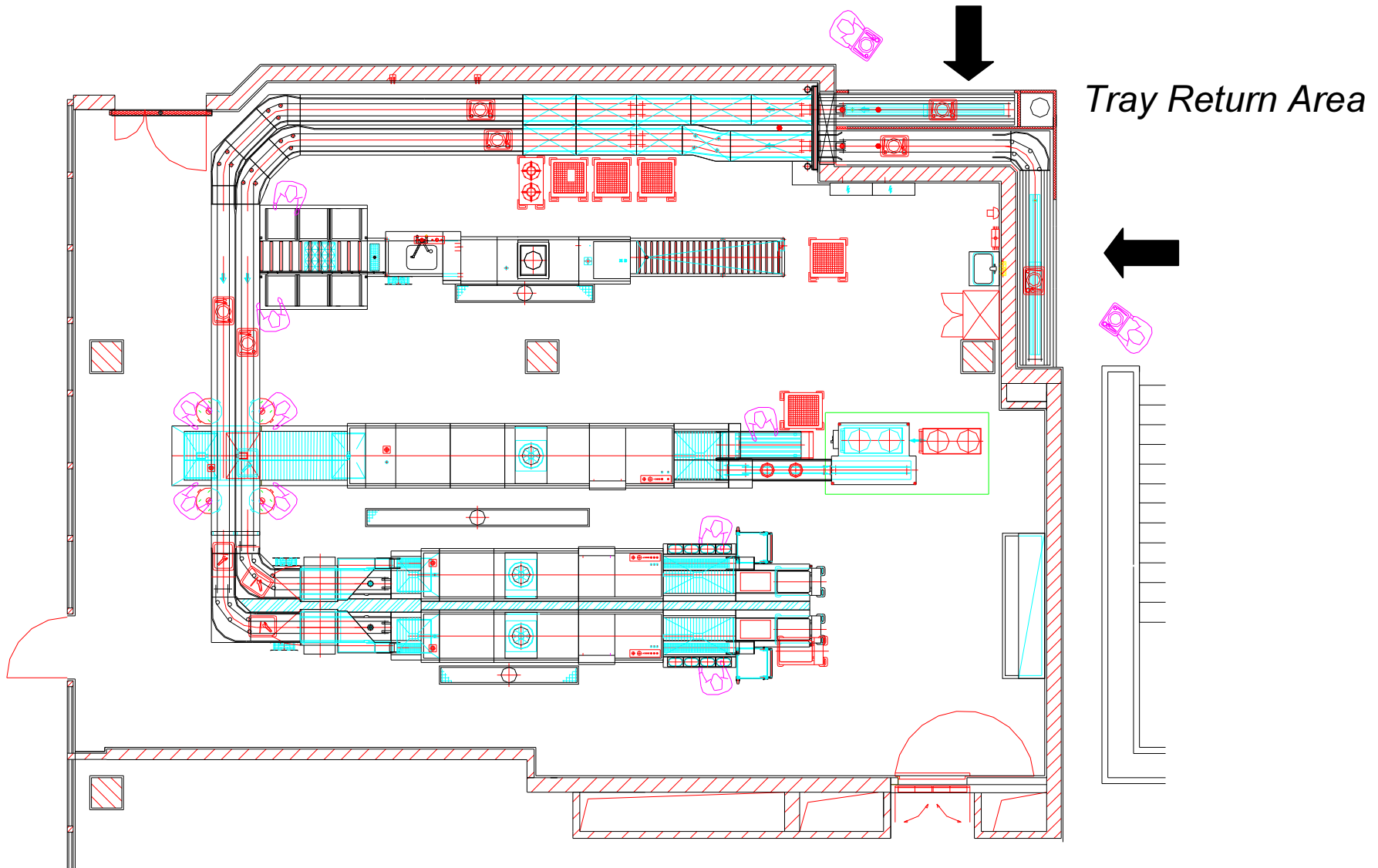

Siemens Karlsruhe



1.) FTN for Plates and Bowls with Lowered Input

2.) FTN for Trays and Silverware with Silverware Collecting Magnet

3.) Additional HOBART Hood-Type Machine for Glassware

Porsche Weissach



1.) FTN for Plates and Bowls with Lowered Input

2.) 2x FTN for Trays and Silverware

3.) Collecting Magnets

DaimlerChrysler Sindelfingen



1.) 2x FTN for Plates and Bowls

2.) 2x FTN for Trays and Silverware with Silverware Dumping and Automatic Stacking of the Trays in a Dispenser

Wet Waste Sanitation Through Integrated ECOLO-Arrangement

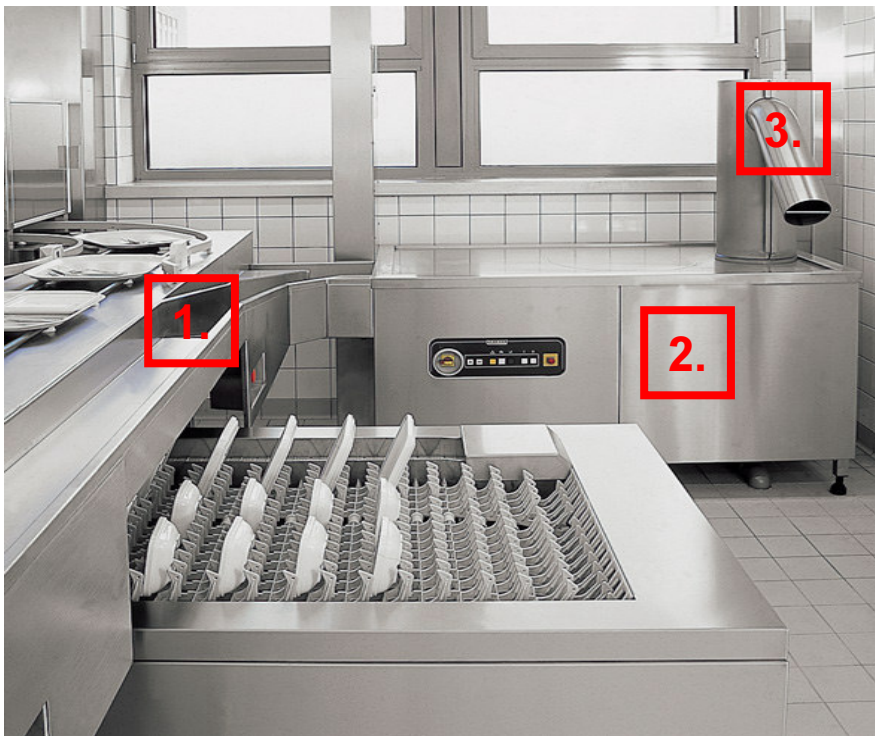

1.) Waste Trough

2.) Eco-Compact Arrangement:
Grinding and Compressing
of the Waste

3.) Wet Waste Discharge

Thank You Very Much For Your Attention

Any Questions...



HOBART

Going into the Future

Take-Off with HOBART

Please Visit Our Website at:

www.hobart.de