

PLEASE NOTE
ALL REQUIRED SERVICE OPENINGS FLOOR/WALL/CEILING FOR THE WAREWASHING EQUIPMENT (EG POWER, WATER, A/E, HOBART RECOMMENDATIONS NOT MENTIONED)
 As continued product improvement is a policy of Hobart, specifications are subject to change without notice.

In case of direct outside vent,
 please arrange for frost protection

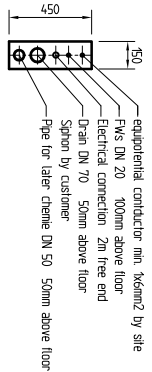
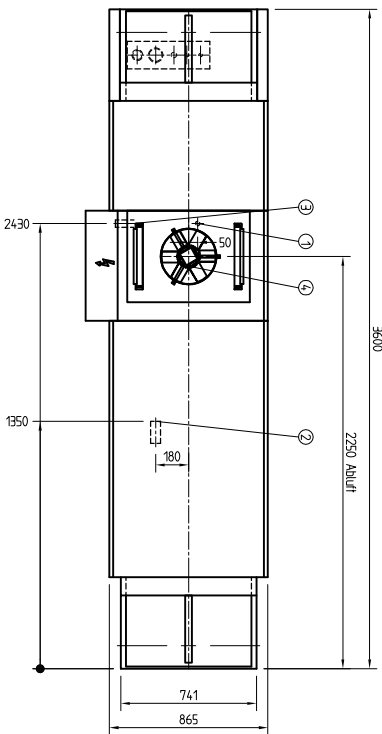

INDEX	QTY	DESCRIPTION	DATE	NAME
1	1	Exhaust connection with fan to adapt to extraction system approx. 350 m ³ /h = 95 l/s		
2	1	Electrical connection : 3 x 400 V / 50 Hz / 3 / PE 35.3kW		
3	1	Case Class section : 5 x 25 mm/2		
4	1	drp water - Siphon by customer		
5	1	Tank drain - Siphon by customer		
6	1	Fresh water connection 2-8" Clark - max 60 °C - 250 l/h for tank fill - 125 l flow pressure min. 2 bar		
7	1	HEATING electric MAIN SWITCH build in		

INDEX	QTY	DESCRIPTION	DATE	NAME
1	1	Exhaust connection with fan to adapt to extraction system approx. 350 m ³ /h = 95 l/s		
2	1	Electrical connection : 3 x 400 V / 50 Hz / 3 / PE 35.3kW		
3	1	Case Class section : 5 x 25 mm/2		
4	1	drp water - Siphon by customer		
5	1	Tank drain - Siphon by customer		
6	1	Fresh water connection 2-8" Clark - max 60 °C - 250 l/h for tank fill - 125 l flow pressure min. 2 bar		
7	1	HEATING electric MAIN SWITCH build in		

DAS UNTERBEREICHT AN DIESEM ZEICHNUNG VERBIEHET BEI DER HOBART CORPORATION ODER EINER HOBART VERBANDSSTELLE, JEDES RECHT AN DEN PATENTEN UND/ODER ANDEREN RECHTSGESCHUTZTEN DOKUMENTEN, VERFAHRENEN, PROZESSEN UND SONSTIGEN RECHTSGESCHUTZTEN DATEN DER HOBART CORPORATION ODER IHRES SUBSIDIARIES, NACH DISKUSSION, REPRODUKTION ODER ANDERER NUTZUNG OHNE DIE SCHRIFTLICHE ZULASSUNG DER HOBART CORPORATION.

HOBART GERMANY HOBART CORPORATION 4620
 ROBERT-ROSE-STRASSE 77656 OEFENBURG GERMANY
 TEL 0781/600-0 TELEFAX 0781/600-2319



DATE: _____ PROJECT: _____
 DRAWN BY: W.L.A. SCALE: 1:20 ORDER-NO.: _____
 CHECKED: _____
 REPLACES DRAWING NO.: _____
 DRAWING NO.: C-600-
 CAD