

AW = drain water (CNS)	KW = cold water	üOKFF = above finished floor
Dat = dataline	KWw = cold water soft	UK = lower edge
EZ = power line 230V / 400V	LR = conduit Ø	VEW = demineralized water
FD = floor opening	CNS = stainless steel (inox)	WD = wall opening
HW-VL = hot water flow	MK = supply channel	WS = wall slot
HW-RL = hot water return	PE = equipotential conductor	WW = warm water
KB = cored hole Ø	STL = control line	WWw = warm water soft

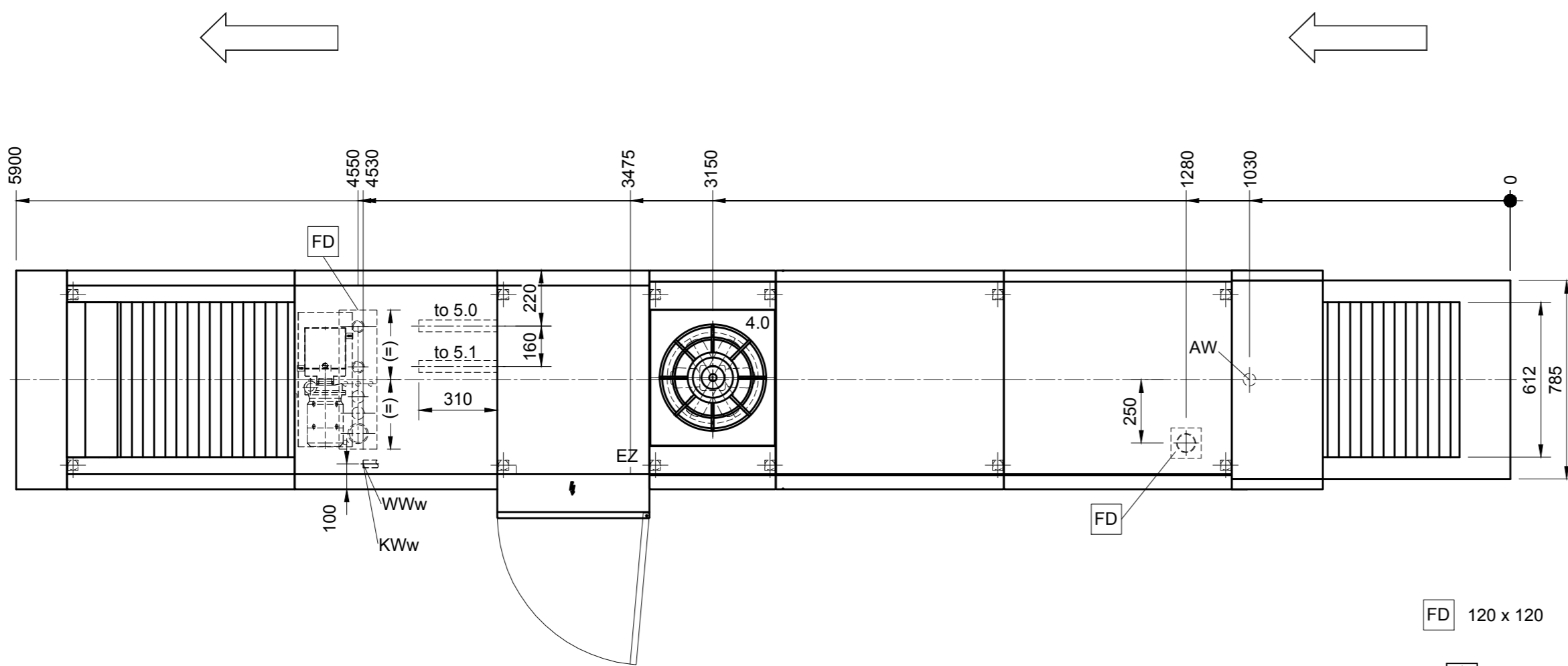
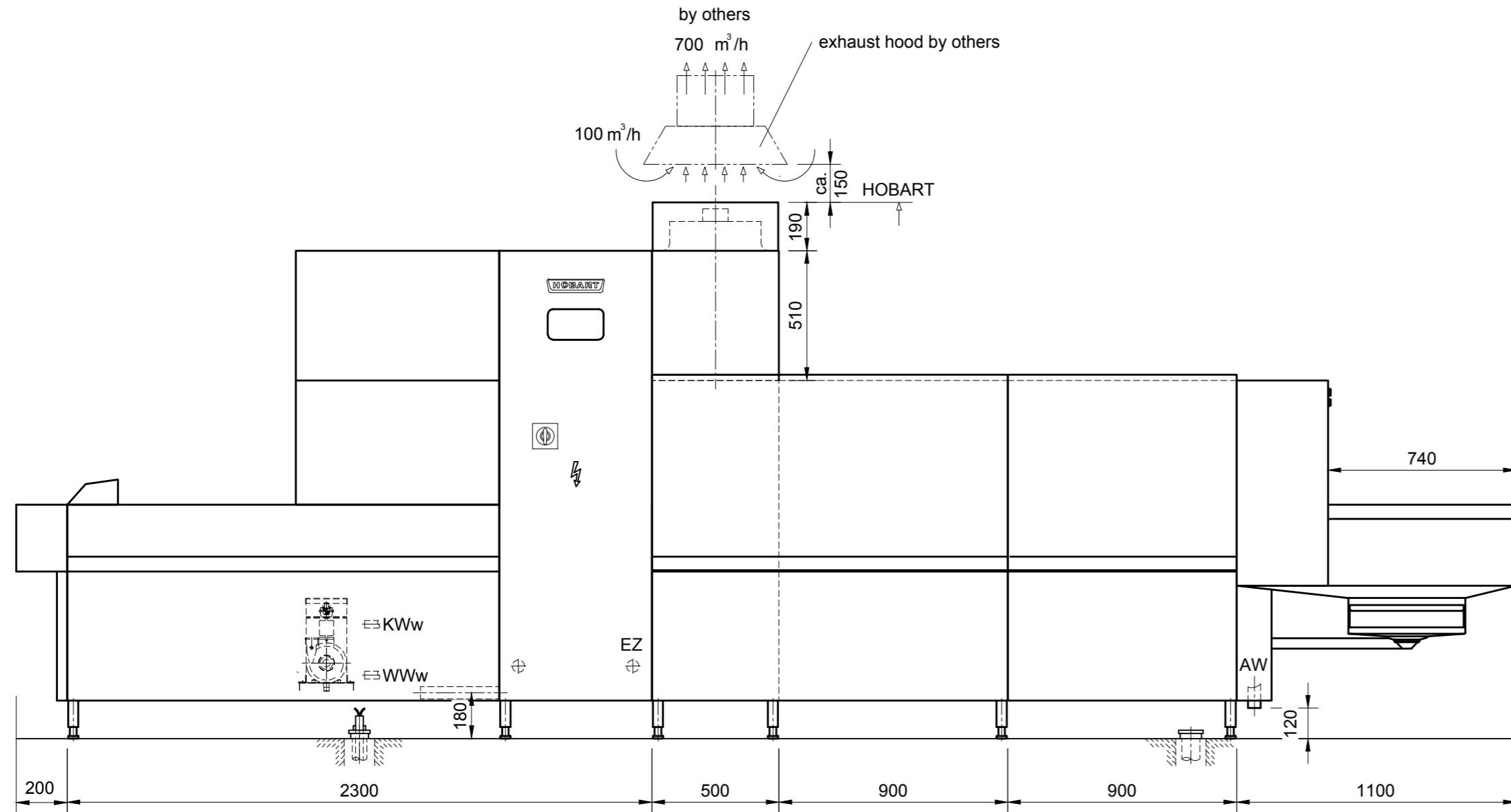

FD 550 x 150

required supply (by others)

FD 120 x 120

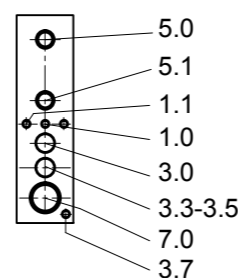

Installation: All installations should always comply with all national and local codes of practice.
Exhaust: A frost-protection flap is recommended if the exhaust air from the machine is exterior ducted.
Transport: Minimum measurements of entry doors for machine assembly = outer measurements of largest machine + 300mm in height, + 400mm in width!
Aeration: The ventilation and exhaust for the room must be interpreted according to local by-laws.
Shut-off valves: The shut-off valves for rinsewater, tankfilling or demi-rinse are supplied by others.
Control- and datalines: We recommend a conduit for control-lines in the area of the electrical connection.
Washing result: A spotless cleaning results can be achieved only with low mineral content of the rinse water. We recommend a conductance of about 80µS/cm.
Floor drain: Splash floor drains should be provided for general cleaning purposes.
Steam- connections: The in-house steam-flow piping must be equipped with condensate drainage prior to the HOBART steam-connection. The in-house condensate piping must be pressure less and able to absorb all HOBART condensate.

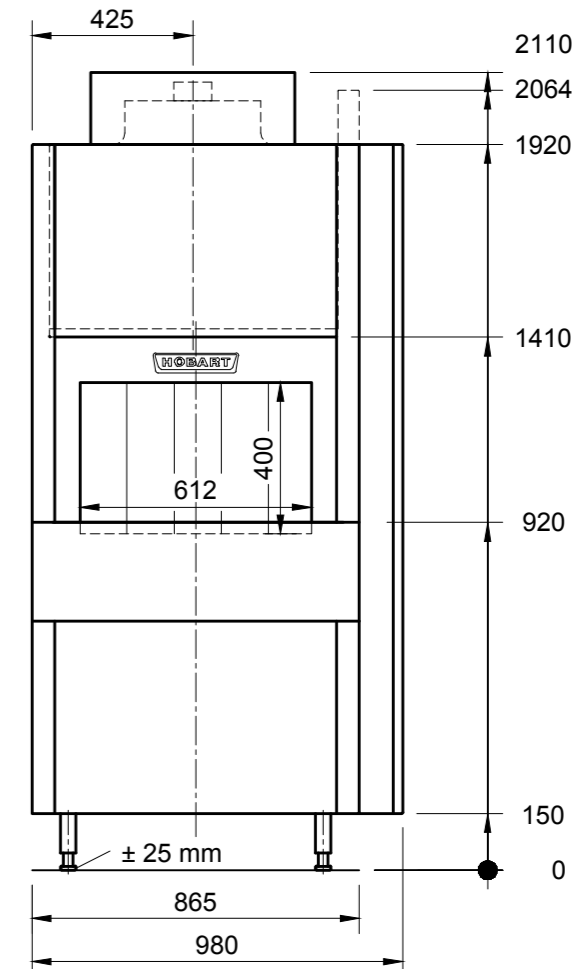

Machine-Type:	Flight-Type Dishwasher	Heating: Steam
Model:	PROFI FTN 2-S-A-DS5, C25	Operation: Right / Left
Usable-Width:	612	Usable-Height:
		400
		Main-Switch: Built in Machine

Chemical	Consumption	Dimension	Position in mm
7.0	conduit for chemical supply	Ø70	100mm AFFL
Heating	Consumption	Dimension	Connection
5.1	Condensate	Ø40	G1 1/2" male
5.0	Steam	56,8 kg/h	118439 kJ/h
		Ø40	G1 1/2" male
Steam-Flow-Pressure provided by customer 0,5-1,0 bar / 7-14 psi			
Exhaust	Volume	Temp.	Humidity
4.0	600 m³/h	32°C	90-98%
			Pressure c.a. 0 Pa
			Dimension Ø300 internal
			Position in mm refer to drawing
Electrical	Control and Data-Line	Extended-Length	
3.7	Equipotential	min. 1x6mm² provided by customer	3m reserve
3.5	Malfunction-Sensor	5x1,5 mm²	3m reserve
3.4	Exhaust	3x1,5 mm²	3m reserve
3.3	Dosage-System	7x1,5 mm²	3m reserve
Electrical	Voltage	Frequency	Supply
3.0	400 V	50 HZ	3-PE
			Fuse 3x20 A
			Cross-Section 4x2,5 mm²
			Power 7,1 kW
			EZ 3m reserve
Water	Consumption	Temp.	Hardness
2.0	Drain	Siphon provided by customer	
1.1	WWw	264 l (Filling)	50-60 °C
1.0	KWw	180 lh	12 °C
			max. 8,75 clark (1,2mmol/l)
			max. 3,75 clark (0,5mmol/l)
			Conductance 150-400µS/cm
			80-120µS/cm
			Dimension Ø70
			Connection Drain pipe
			Position in mm 50mm AFFL
			Ø20
			G3/4" male
			100mm AFFL
			Ø20
			G3/4" male
			100mm AFFL
Water-Flow-Pressure provided by customer min. 1,5 bar / 22 psi			
Heat-Radiation (thermal output to the room)			
washware	8,7 kW	latent: 2,0 kW	sensible 4,3 kW

Index	Änderungen / Changes	Datum / Date	Name
-------	----------------------	--------------	------

Das Urheberrecht an dieser Zeichnung verbleibt bei der HOBART GmbH.
 Jede nicht von uns schriftlich genehmigte Benutzung, Vervielfältigung, Überlassung an Dritte ist strafbar und macht schadensersatzpflichtig.
 This document contains proprietary and confidential data of HOBART GmbH. No disclosure, reproduction or use of any part thereof may be made without written permission of HOBART GmbH.

HOBART HOBART GmbH - Robert-Bosch-Straße17 - 77656 Offenburg, Germany
 Tel.: +49(0)781.600-0 - Fax.: +49(0)781.600-2319 - www.hobart.de

Angebot Quotation
 Bestellung Order

Datum / Date:	02.11.2011	Project:	
Gezeichnet / Drawn by:	R.Leonhardt	Maßstab / Scale:	1:20
Geprüft / Checked by:	R.H.	Order-No.:	
Projectmanager:	XXXX	Zeichnungsnummer / Drawing-No.:	FTN SF 6x4 2-S-A-DS5, C25 RL