

AW = drain water (CNS)	KW = cold water	üOKFF = above finished floor
Dat = dataline	KWw = cold water soft	UK = lower edge
EZ = power line 230V / 400V	LR = conduit Ø	VEW = demineralized water
FD = floor opening	CNS = stainless steel (inox)	WD = wall opening
HW-VL = hot water flow	MK = supply channel	WS = wall slot
HW-RL = hot water return	PE = equipotential conductor	WW = warm water
KB = cored hole Ø	STL = control line	WWw = warm water soft

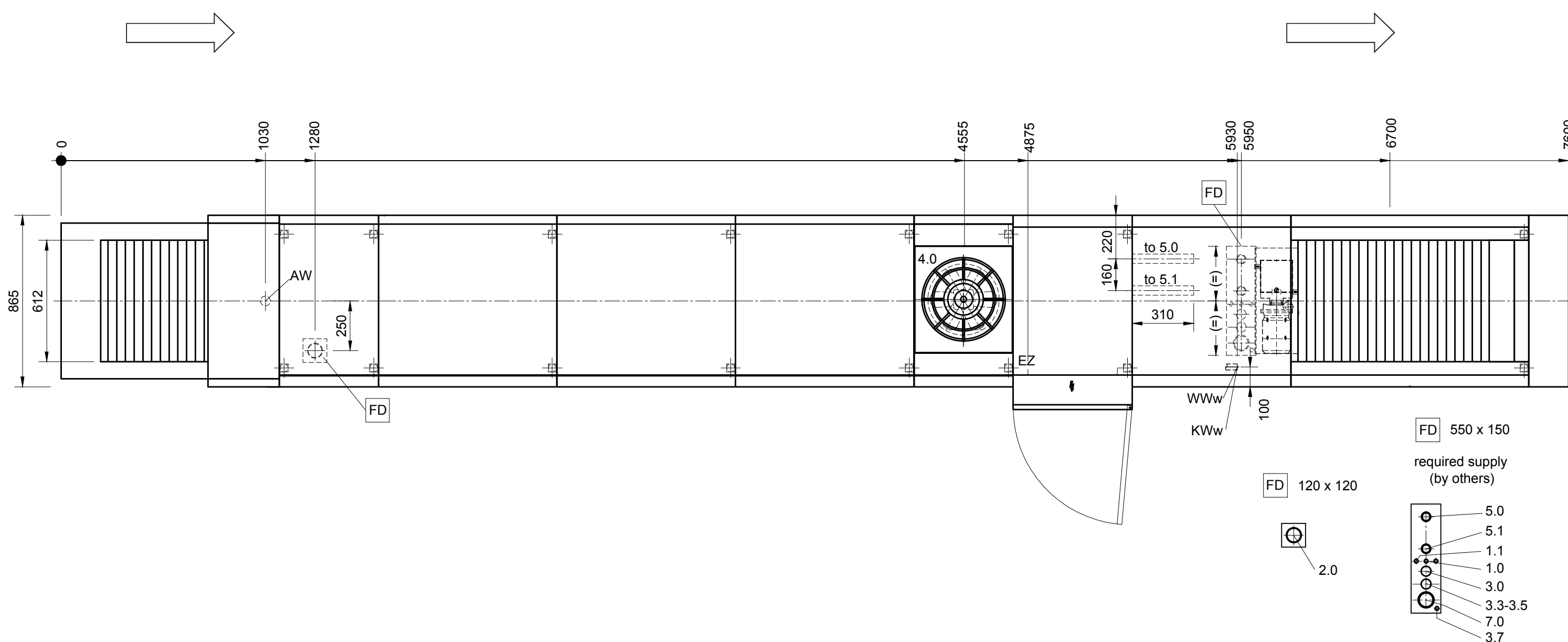

**Installation:** All installations should always comply with all national and local codes of practice.  
**Exhaust:** A frost-protection flap is recommended if the exhaust air from the machine is exterior ducted.  
**Transport:** Minimum measurements of entry doors for machine assembly = outer measurements of largest machine + 300mm in height, + 400mm in width!  
**Aeration:** The ventilation and exhaust for the room must be interpreted according to local by-laws.  
**Shut-off valves:** The shut-off valves for rinsewater, tankfilling or demi-rinse are supplied by others.  
**Control- and datalines:** We recommend a conduit for control-lines in the area of the electrical connection.  
**Washing result:** A spotless cleaning results can be achieved only with low mineral content of the rinse water. We recommend a conductance of about 80µS/cm.  
**Floor drain:** Splash floor drains should be provided for general cleaning purposes.  
**Steam- connections:** The in-house steam-flow piping must be equipped with condensate drainage prior to the HOBART steam-connection. The in-house condensate piping must be pressure less and able to absorb all HOBART condensate.

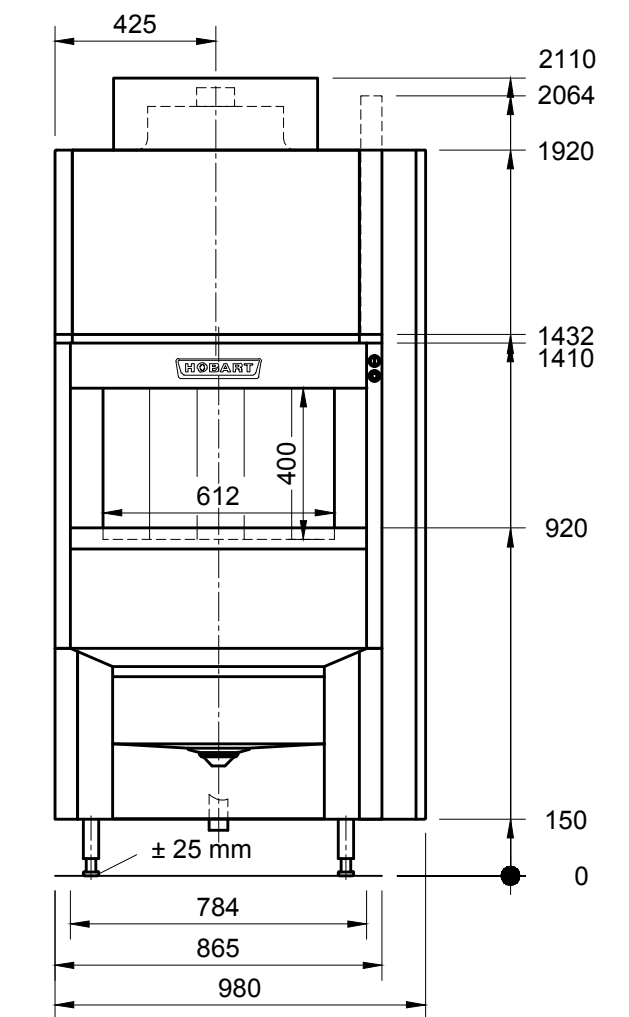
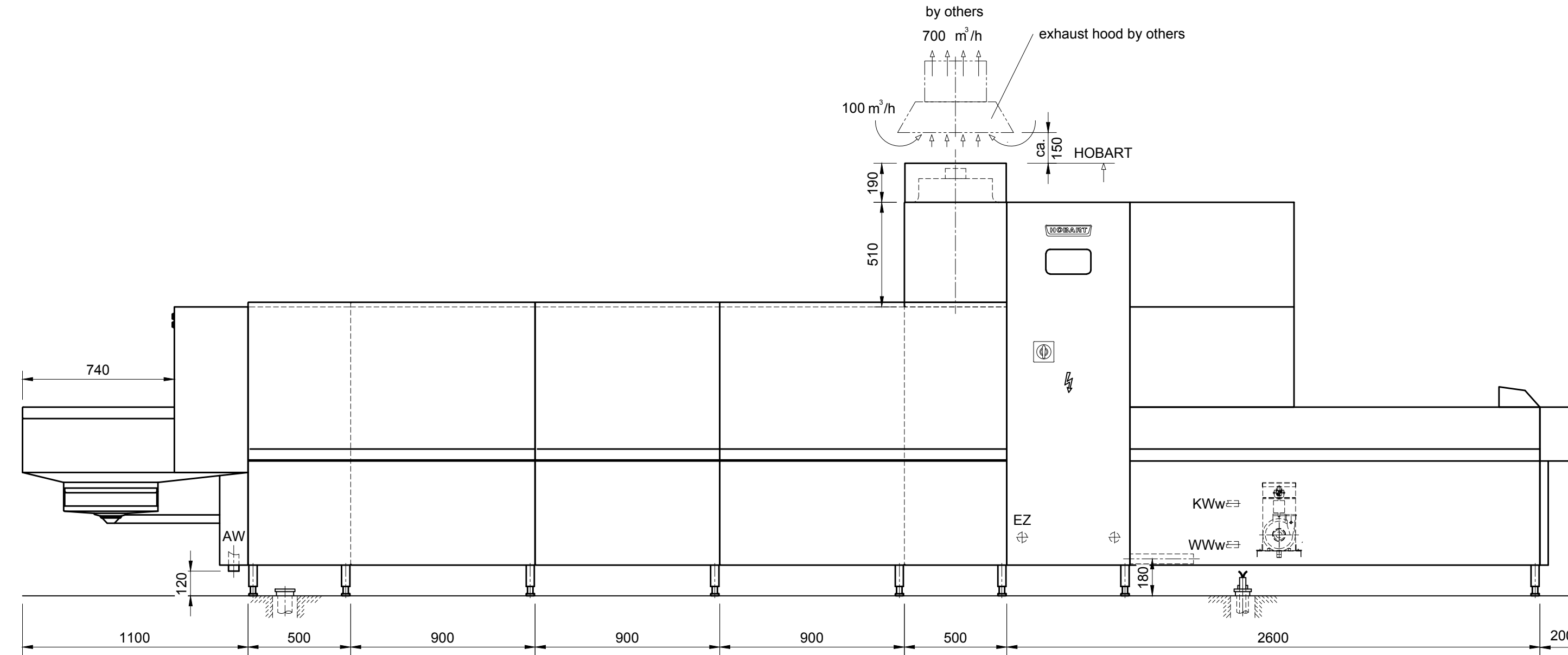

<b>Machine-Type:</b>	<b>Flight-Type Dishwasher</b>	<b>Heating:</b>	<b>Steam</b>
<b>Model:</b>	<b>PROFI FTN 2-E-S-A-A-DS6, C25</b>	<b>Operation:</b>	<b>Left / Right</b>
<b>Usable-Width:</b>	<b>612</b>	<b>Usable-Height:</b>	<b>400</b>
		<b>Main-Switch:</b>	<b>Built in Machine</b>

Chemical	Consumption	Temp.	Humidity	Pressure	Dimension	Position in mm
7.0					conduit for chemical supply	Ø70 100mm AFFL
<b>Heating</b>						
5.1	Condensate					Ø40 G1½" male 100mm AFFL
5.0	Steam	61,9 kg/h	129206 kJ/h			Ø40 G1½" male 100mm AFFL
Steam-Flow-Pressure provided by customer <b>0,5-1,0 bar / 7-14 psi</b>						
<b>Exhaust</b>						
4.0	Volume	Temp.	Humidity	Pressure	Dimension	Position in mm
	600 m³/h	32°C	90-98%	c.a. 0 Pa	Ø300 internal	refer to drawing
<b>Electrical</b>						
Control and Data-Line						
3.7	Equipotential				min. 1x6mm² provided by customer	3m reserve
3.5	Malfunction-Sensor				5x1,5 mm²	STL 3m reserve
3.4	Exhaust				3x1,5 mm²	STL 3m reserve
3.3	Dosage-System				7x1,5 mm²	STL 3m reserve
<b>Electrical</b>						
3.0	Voltage	Frequency	Supply	Fuse	Cross-Section	Power
	400 V	50 HZ	3-PE	3x20 A	4x4 mm²	9,3 kW
<b>Water</b>						
2.0	Consumption	Temp.	Hardness	Conductance	Dimension	Connection
	409,5 l (Filling)	50-60 °C	max. 8,75 clark (1,2mmol/l)	150-400µS/cm	Ø70	Drain pipe 50mm AFFL
1.1	WWw	12 °C	max. 3,75 clark (0,5mmol/l)	80-120µS/cm	Ø20	G3/4" male 100mm AFFL
1.0	KWw				Ø20	G3/4" male 100mm AFFL
Water-Flow-Pressure provided by customer <b>min. 1,5 bar / 22 psi</b>						
Heat-Radiation (thermal output to the room)						
	washware	13,8 kW	latent	2,3 kW	sensible	5,0 kW

Index	Änderungen / Changes	Datum / Date	Name

Das Urheberrecht an dieser Zeichnung verbleibt bei der HOBART GmbH.  
 Jede nicht von uns schriftlich genehmigte Benutzung, Vervielfältigung, Überlassung an Dritte ist strafbar und macht schadensersatzpflichtig.  
 This document contains proprietary and confidential data of HOBART GmbH. No disclosure, reproduction or use of any part thereof may be made without written permission of HOBART GmbH.

**HOBART** HOBART GmbH - Robert-Bosch-Straße 17 - 77656 Offenburg, Germany  
 Tel.: +49(0)781.600-0 - Fax.: +49(0)781.600-2319 - www.hobart.de

Angebot  Quotation  
 Bestellung  Order

Datum / Date:	02.11.2011	Project:	
Gezeichnet / Drawn by:	R.Leonhardt	Maßstab / Scale:	1:20
Geprüft / Checked by:	R.H.	Order-No.:	
Projectmanager:	XXXX	Zeichnungsnummer / Drawing-No.:	FTN SF 6x4 2-E-S-A-A-DS6, C25 LR