

AW = drain water (CNS)	KW = cold water	üOKFF = above finished floor
Dat = dataline	KWw = cold water soft	UK = lower edge
EZ = power line 230V / 400V	LR = conduit Ø	VEW = demineralized water
FD = floor opening	CNS = stainless steel (inox)	WD = wall opening
HW-VL = hot water flow	MK = supply channell	WS = wall slot
HW-RL = hot water return	PE = equipotential conductor	WW = warm water
KB = cored hole Ø	STL = control line	WWw = warm water soft

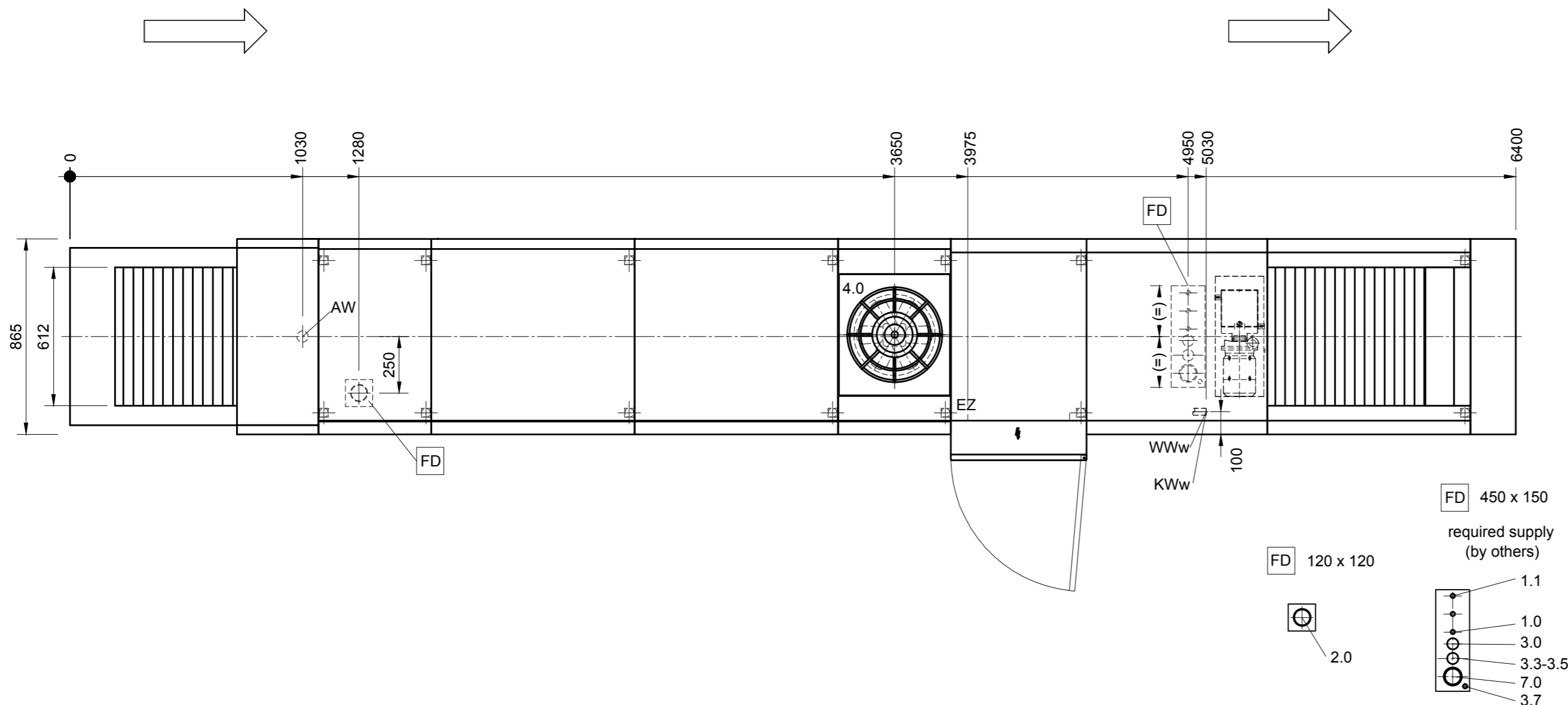

Installation: All installations should always comply with all national and local codes of practice.
Exhaust: A frost-protection flap is recommended if the exhaust air from the machine is exterior ducted.
Transport: Minimum measurements of entry doors for machine assembly = outer measurements of largest machine + 300mm in height, + 400mm in width!
Aeration: The ventilation and exhaust for the room must be interpreted according to local by-laws.
Shut-off valves: The shut-off valves for rinsewater, tankfilling or demi-rinse are supplied by others.
Control- and datalines: We recommend a conduit for control-lines in the area of the electrical connection.
Washing result: A spotless cleaning results can be achieved only with low mineral content of the rinse water. We recommend a conductance of about 80µS/cm.
Floor drain: Splash floor drains should be provided for general cleaning purposes.

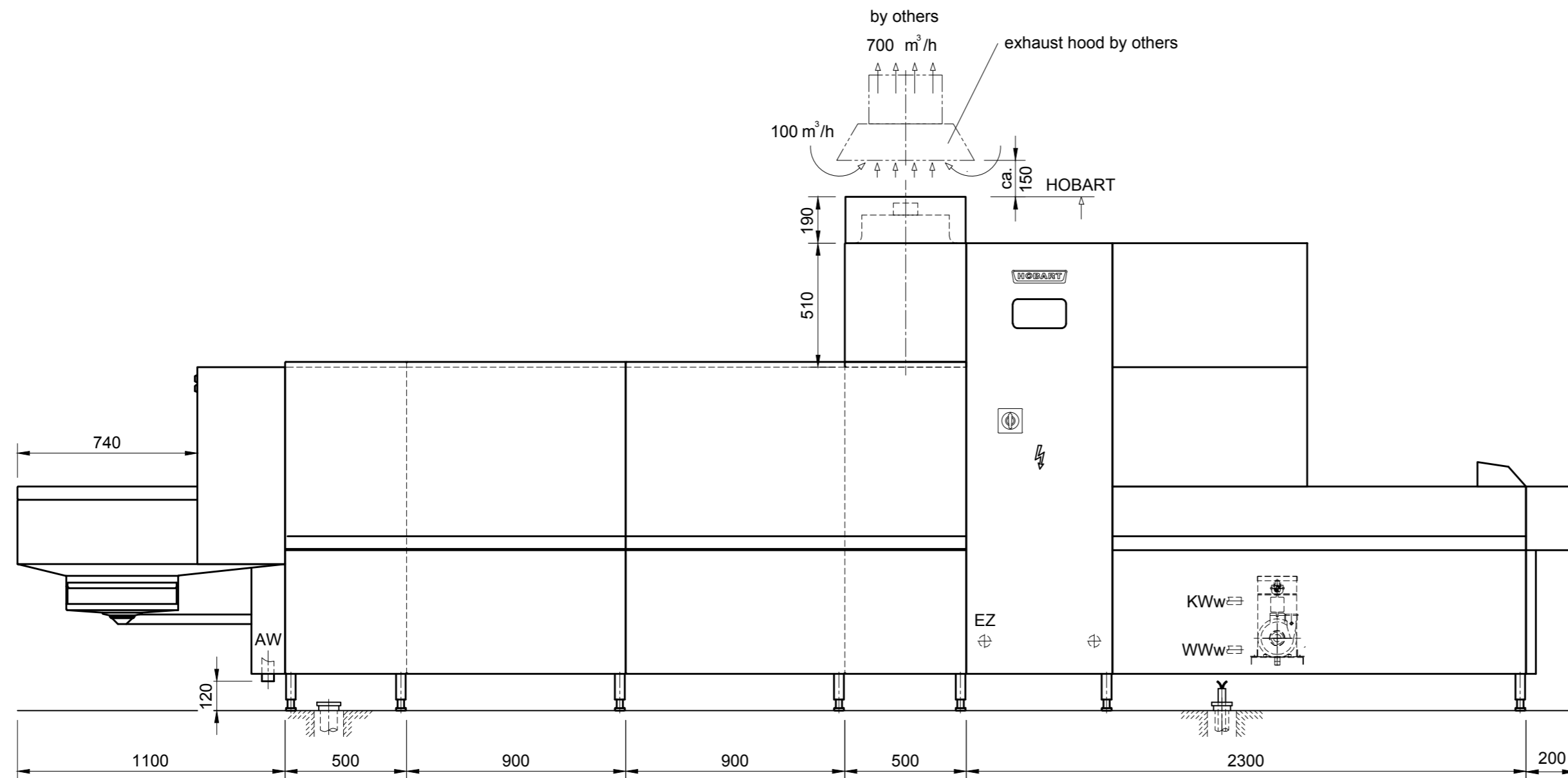
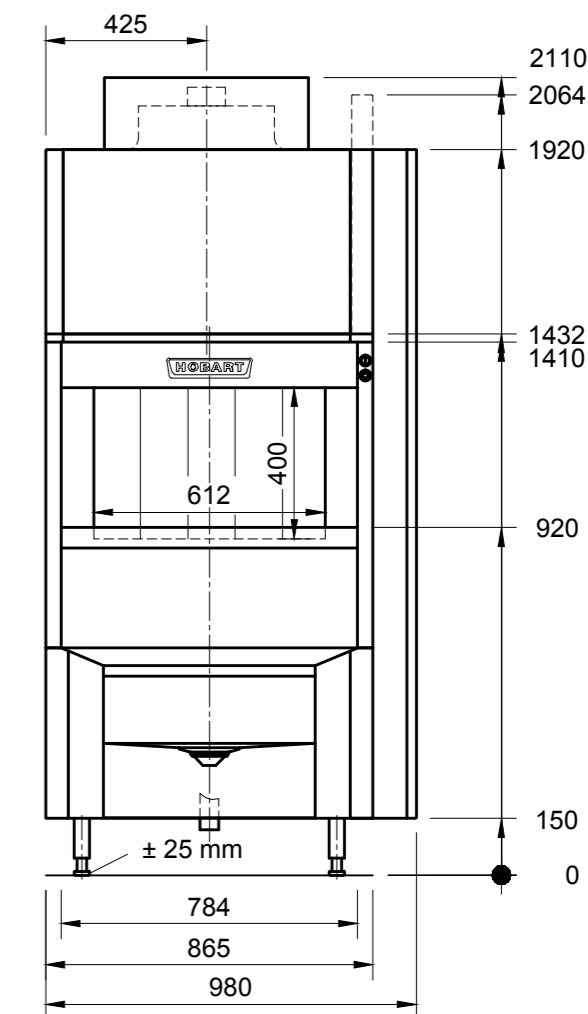

Machine-Type:	Flight-Type Dishwasher	Heating: Electrical
Model: PROFI FTN	2-E-S-A-DS5, C25	Operation: Left / Right
Usable-Width: 612	Usable-Height: 400	Main-Switch: Built in Machine

Chemical		Dimension			Position in mm			
7.0	conduit for chemical supply	Ø70			100mm AFFL			
Exhaust		Volume	Temp.	Humidity	Pressure	Dimension		
4.0		600 m³/h	32°C	90-98%	ca. 0 Pa	Ø300 internal		
refer to drawing								
Electrical		Control and Data-Line			Extended-Length			
3.7	Equipotential	min. 1x6mm² provided by customer			3m reserve			
3.5	Malfunction-Sensor	5x1.5 mm²			STL 3m reserve			
3.4	Exhaust	3x1.5 mm²			STL 3m reserve			
3.3	Dosage-System	7x1.5 mm²			STL 3m reserve			
Electrical		Voltage	Frequency	Supply	Fuse	Cross-Section	Power	Extended-Length
3.0		400 V	50 HZ	3-PE	3x60 A	4x25 mm²	40,1 kW	EZ 3m reserve
Water		Consumption	Temp.	Hardness	Conductance	Dimension	Connection	Position in mm
2.0		Drain (Siphon provided by customer)				Ø70	Drain pipe	50 mm AFFL
1.1	WWw	284.5 l (Filling)	50-60 °C	max. 8,75 clark (12mmol/l)	150-400µS/cm	Ø20	G3/4" male	100mm AFFL
1.0	KWw	180 lh	12 °C	max. 3,75 clark (0,5mmol/l)	80-120µS/cm	Ø20	G3/4" male	100mm AFFL

Water-Flow-Pressure provided by customer min. 1,5 bar / 22 psi			
Heat-Radiation (thermal output to the room)			
washware	10,5 kW	latent	2,0 kW
		sensible	4,5 kW
Index	Änderungen / Changes	Datum / Date	Name

Das Urheberrecht an dieser Zeichnung verbleibt bei der HOBART GmbH.
 Jede nicht von uns schriftlich genehmigte Benutzung, Vervielfältigung, Überlassung an Dritte ist strafbar und macht schadensersatzpflichtig.
 This document contains proprietary and confidential data of HOBART GmbH. No disclosure, reproduction or use of any part thereof may be made without written permission of HOBART GmbH.

HOBART	HOBART GmbH - Robert-Bosch-Straße17 - 77656 Offenburg, Germany Tel.: +49(0)781.600-0 - Fax.: +49(0)781.600-2319 - www.hobart.de	Angebot <input type="checkbox"/> Quotation Bestellung <input type="checkbox"/> Order
---------------	--	---

Datum / Date: 02.11.2011	Project:	Maßstab / Scale: 1:20	Order-No.:	Zeichnungsnummer / Drawing-No.:
Gezeichnet / Drawn by: R.Leonhardt				FTN EF 6x4 2-E-S-A-DS5, C25 LR
Geprüft / Checked by: R.H.				
Projectmanager: XXXX				